

A One Water Story – Realizing the Environmental and Economic Value of One Water for the Texas Hill Country

Summer 2012

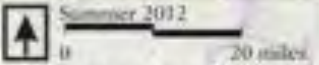

Sources: HCA, TNRS, ESRI, TCDQ
Produced for HCA by Siglo Group

- Edwards Aquifer Recharge Zone
- Edwards Aquifer Contributing Zone
- Trinity Aquifer Recharge Zone
- Comal Aquifer Recharge Zone
- River Basin Boundary
- Water Catchment Boundary

© The geographic area of the Texas Hill Country and the surrounding area of the Edwards Aquifer Recharge Zone.







THE MEADOWS CENTER FOR WATER AND THE ENVIRONMENT

No natural resource is more important to our future than Water. Water is what we do.

RESEARCH | STEWARDSHIP | SERVICE | EDUCATION



THE MEADOWS CENTER
FOR WATER AND THE ENVIRONMENT

TEXAS STATE UNIVERSITY



Primary Threats to Water Quality in the Wimberley Valley

Declining groundwater levels – reduced spring flows result in worsening water quality for Cypress Creek and Blanco River

Impacts of drought – lower flows, increased temperatures negatively affect dissolved oxygen and bacteria growth

Growth, development – increased impervious cover/increased stormwater flows; nonpoint source pollution from homes, cars, businesses; changes in wildlife habitat/patterns; aging infrastructure



CYPRESS CREEK

Let's keep it **clean**, **clear** & flowing



Celebrating 10 Years

Of stakeholder-driven watershed protection in the Cypress Creek Watershed



THE MEADOWS CENTER
FOR WATER AND THE ENVIRONMENT
TEXAS STATE UNIVERSITY

TEXAS STATE UNIVERSITY
The rising STAR of Texas



GUADALUPE-BLANCO RIVER AUTHORITY



Texas Water
Development Board



United States
Environmental Protection
Agency



TEXAS COMMISSION
ON ENVIRONMENTAL QUALITY



The City of
Woodcreek
IN THE MIDST OF THE TEXAS HILL COUNTRY



TEXAS A&M
AGRI LIFE
EXTENSION

The Nature
Conservancy



THE MEADOWS CENTER
FOR WATER AND THE ENVIRONMENT
TEXAS STATE UNIVERSITY

TEXAS STREAM TEAM

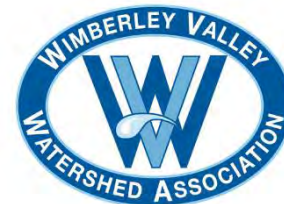

HAYS TRINITY
GROUNDWATER
CONSERVATION DISTRICT



Cypress Creek Watershed Protection

- Activities to prevent pollution, protect flow
- Preserve water quality through local permitting, ordinances
- Improve tools for decision makers to calculate effects of land use changes on water quality
- Site-specific LID/Green Infrastructure demonstration sites
- Outreach and education efforts
- Monitoring and modeling water quality changes

Simply Stated:

The Cypress Creek Watershed Protection Plan aims to ensure that the long-term integrity and sustainability of the Cypress Creek watershed is preserved and that water quality standards are maintained for present and future generations.

A New Primary School for Wimberley ISD

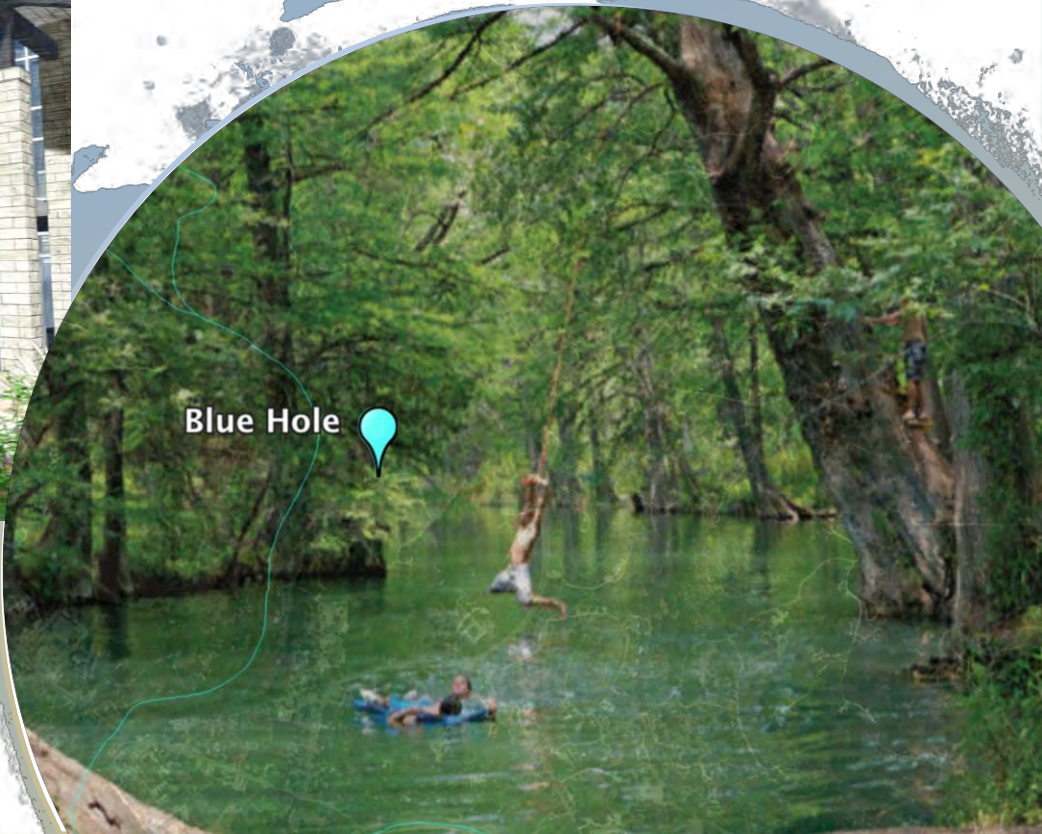

WISD Primary School Environmental Concerns

- Conversion of native range to developed site
- Standard construction w/ minimal water conservation practices (20 gal. per student/day)
- Wastewater mindset with raw sewage to be transported to off-site WWTP (additional infrastructure including lift station needed)
- Water supply from already stressed Cow Creek aquifer... the source of flow for Jacob's Well Spring
- Stormwater impacts to ephemeral tributary and Cypress Creek with no enhanced GSI
- A MISSED OPPORTUNITY

A solution?

A One Water School for Wimberley ISD

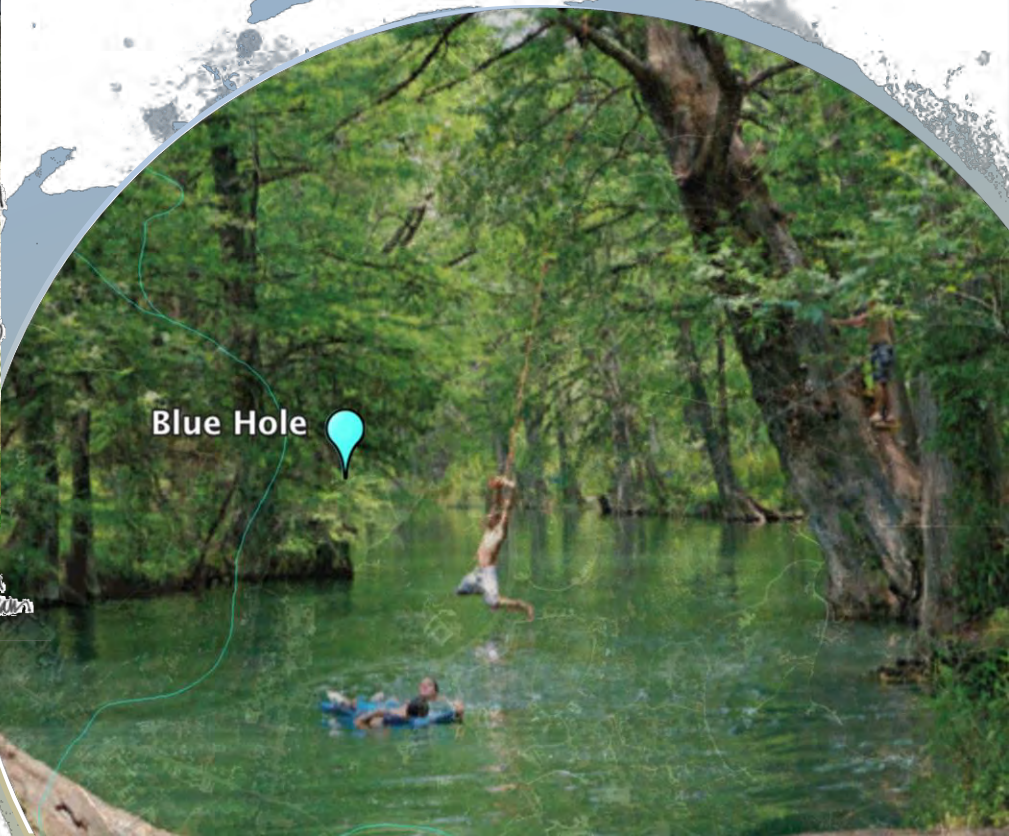

WHAT IS ONE WATER?

An intentionally INTEGRATED approach to water

One Water

promotes the management of **all water** — drinking water, wastewater, stormwater, greywater— as a **single resource**.

Across types
of water

Across
regions/
watersheds

ALL WATER IS ONE WATER



ADVANCING
ONE WATER
IN TEXAS



THE CYNTHIA & GEORGE
MITCHELL
FOUNDATION

<https://cgmf.org/p/one-water-report.html>

Pathways to a *One Water* Future

- *Collaboration...* with a wide variety of stakeholders and engagement with the community
- *Economics and finance...* that recognize the true cost of water, prices it accordingly, and are attractive for public and private investors
- *Green Infrastructure...* that works with and mimics nature
- *Closed-loop system...* that enhance nutrient and energy recovery and encourage water sensitive behaviors
- *Built Environment...* with multifunctional infrastructure that supplements the natural environment
- *Enabling conditions...* that foster innovative institutional and management arrangements
- *Flexible and adaptive...* to allow for innovation and strengthen

One Water standards as presented by Howe, C. and Mukhebeir, P., "Pathways to One Water: A guide for Institutional Innovation." Water Environment & Reuse Foundation, 2015

~~Wastewater~~ as a Water Supply

The ~~Wastewater~~ Cycle

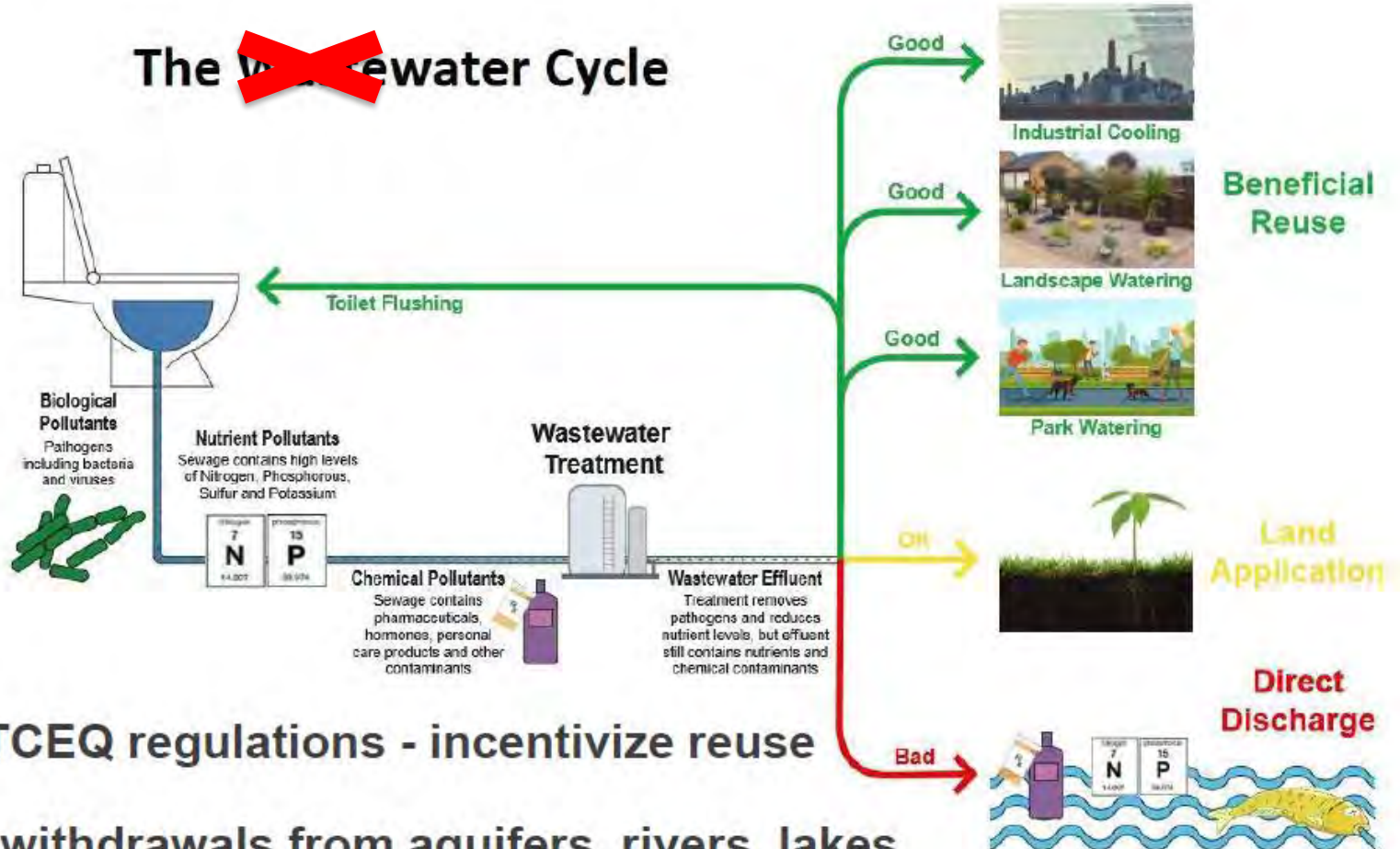

- Modify TCEQ regulations - incentivize reuse
- Reduce withdrawals from aquifers, rivers, lakes
- Preserve aquifers and streams natural character

WISD *One Water* Opportunities

- Rainwater Harvesting and HVAC Condensate Collection
- Green Stormwater Infrastructure
- Onsite sewage treatment and beneficial reuse
- Water-efficient plumbing fixtures
- Incorporate *One Water* Education
- Reduce potable water demand and protect springflow
- Demonstrate economic benefits of *One Water* approach

WISD *One Water* Challenges

- Timing
- Requires Education
 - Elected officials, general contractor, architects, ENGINEERS, watershed stakeholders, and US!
- Requires Courage
 - Technology is still innovative w/ few Texas examples
 - Permitting processes do not incentivize reuse... treat wastewater as a nuisance that needs to be “disposed”
- Requires Investment
- Dare to Lead!

Overcoming **WISD** *One Water* **Challenges**

- Getting started
 - *Crucial Conversations* – “start with heart”
 - *7 Habits* – “begin with the end in mind”
- Project research, stakeholder feedback, identifying key players
- Coffee with the Superintendent No. 1
- Coffee with the Superintendent No. 2
- A little help from our friends: a *WISD One Water Team*
- Technical and feasibility study
- Meeting with the WISD project team – GC, Architect, Engineer
- Presentation to the School Board No. 1
- More work...technical and fundraising
- Presentation to the School Board No. 2

Stormwater Management

- Protect Water Quality & Conserve Water Quantity



Water Collection + Onsite Wastewater Reuse

- RECIRCULATING PACKED-BED FILTER SYSTEM
- FIRST COST SAVINGS - \$300,000 *based on 7500/day system
- POTENTIAL SAVINGS VS CONVENTIONAL SYSTEM
 - OVER 30 YEARS ANNUALLY \$20,000 - \$30,000
- CASE STUDY – ORENCO SCHOOL – ADVANTEX
- PARALLEL PERMITTING APPROACH WITH HAYS & TCEQ



Andrada Polytechnic and Patano High School, Arizona.



Conventional vs One-Water Cost Summary

WATER SUBSYSTEM	COST TYPE	CONVENTIONAL	ONE-WATER
WASTE WATER + REUSE	CAPITAL COST	\$ 750,000	\$ 446,778
	ANNUAL O & M COST	\$ 26,695	\$ 6,000
RAINWATER + AC CONDENSATE COLLECTION FOR TOILET FLUSHING	CAPITAL	\$ -	\$ 250,000
	ANNUAL O & M COST	\$ 19,488	\$ 10,188
STORMWATER MANAGEMENT (LID & GREEN INFRASTRUCTURE)	CAPITAL COST	\$ -	\$ 125,000
	ANNUAL O & M COST	\$ -	\$ -
SUM TOTAL ALL WATER SYSTEMS	CAPITAL + 30 YEAR O & M COST	\$ 2,135,490	\$ 1,307,418

Benefits: Bringing It All Together

- FOR WISD:
 - Reduced capital and operating costs
 - Establish leadership in the community on a flagship site
- FOR THE COMMUNITY
 - A catalyst for creating a watershed culture
 - A Living Lab for integrated water management
- FOR THE CHILDREN
 - Healthier and smarter kids
 - Engaging and Inspirational Learning Experience



Overcoming **WISD** *One Water* **Challenges**

- Unanimous approval of WISD Board of Trustees:
 - Memorandum of Understanding to embed *One Water Team* for developing final design, bid and construction oversight



LOCAL

Wimberley school to make history as first 'One Water' school in Texas

A 'One Water' school means it will use 90 percent less groundwater than a typical school of this size.

Author: Shawna Reding

Published: 8:04 AM CST December 3, 2018

Updated: 11:06 AM CST December 3, 2018

Realizing *One Water* Opportunities

- Rainwater Harvesting and HVAC Condensate Collection
 - Dual plumbing for toilet flushing with RWH & HVAC
 - Supplemental irrigation for landscape and school gardens
- Green Stormwater Infrastructure
 - Raingardens, pervious surfaces
 - Pollutant reduction, flood mitigation, groundwater recharge
- Onsite sewage treatment and beneficial reuse
 - Reliable, Low Energy, packed bed recirculating filter treatment system with subsurface drip irrigation for athletic fields
- Efficiencies - Potable water demand reduced by 90% protecting springflow
- WISD will save an estimated \$1,000,000 over the next 30 years on water/wastewater O&M costs

EDUCATION: from Good to *One Water* Great!

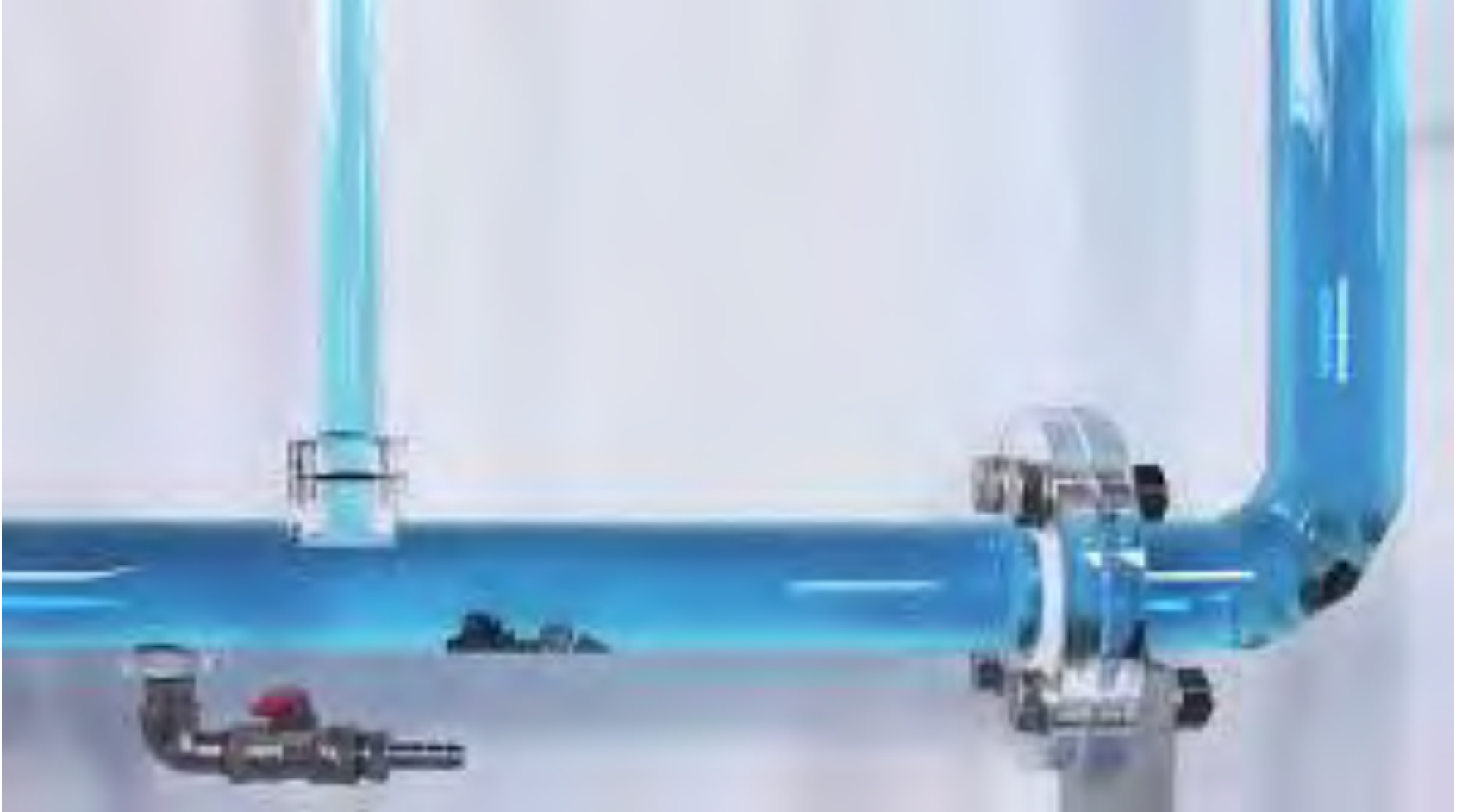

Next Step: A *One Water* Master Plan:

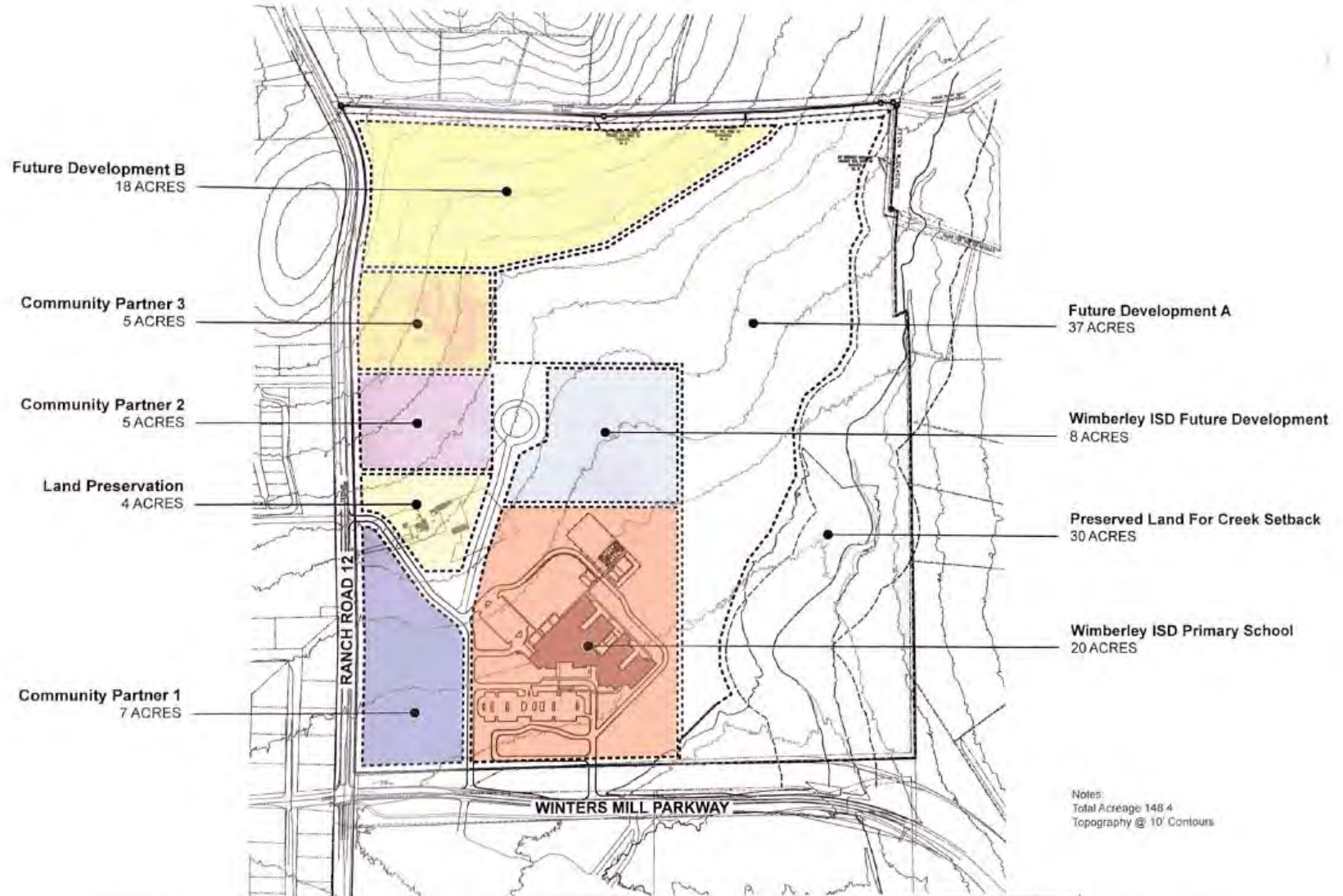

Dr. Robert Mace
Executive Director

Nick Dornak
Director of Watershed Services

nickdornak@txstate.edu

512-245-6697

No natural resource is more important to our future than Water. Water is what we do.

RESEARCH | STEWARDSHIP | SERVICE | EDUCATION | SERVICE



THE MEADOWS CENTER
FOR WATER AND THE ENVIRONMENT

TEXAS STATE UNIVERSITY