

DIVISION 10 - SPECIALTIES

SECTION 10 14 01 – EXTERIOR SITE SIGNAGE

PART 1: GENERAL

1.01 Scope of Standard

- A. This standard provides general guidance concerning the specific preferences of Texas State University for signage designed and configured for exterior site installation.
- B. Texas State University recognizes that project conditions and requirements vary, thus precluding the absolute adherence to the items identified herein in all cases. However, unless there is adequate written justification, it is expected that these guidelines will govern the design and specifications for Texas State University projects.

1.02 Design Guidelines

- A. Building Identification Signs:
 1. Each new building requires a Building Identification Sign which conforms to Texas Sate Sign Standards. The exterior site signage will be a part of the construction contract.
 2. Reference Standards: Vendor to provide signs that comply with the Texas State University design and specifications intent of the exterior signage as maintained in Texas State University Facilities Department.
 - a. EXHIBIT 1: Building Name Sign (Secondary – verbiage on one side)
 - b. EXHIBIT 2: Building Name Sign (Primary – verbiage on both sides)
 - c. EXHIBIT 3: Sherwin-Williams Custom Paint Codes
 3. If required, the contractor shall provide signs which comply with the Americans with Disabilities Act Accessibility Guidelines (ADAAG).
 4. Submittals: Full shop drawing of each sign type must be submitted to Texas State University for approval.
 - a. One full size mock-up of a typical sign must be submitted for quality of construction approval by Texas State University.
 - b. The mockup can be used for installation, once all wording is approved.
 5. Building Address: For signs including building address, confirm street address with FPDC prior to submission of submittal.
- B. Regulatory Site Signs (stop, no parking, accessible parking)
 1. No construction Standards have been developed for these signs. A/E to select and submit for approval.

2. Support poles and backs of regulatory signs are to be painted Sherwin Williams SW 6258 "Tricorn Black", semi-gloss finish.
 - a. All poles (except Stop Signs): Place yellow reflective tape completely around pole, starting 48" off pavement.
 - b. Stop Sign Poles ONLY: Place red reflective tape completely around pole, starting at 48" off pavement.

PART 2: PRODUCTS

1.03 Building Identification Signs

- A. Manufacturers are subject to compliance with these requirements.
- B. Asbestos and PCB Certification: After completion of installation, but prior to Substantial Completion, Contractor shall certify in writing that products and materials installed, and processes used, do not contain asbestos or polychlorinated biphenyls (PCB).

PART 3: EXECUTION

- A. Installation of Exterior Site Post-Mounted Signs foundation and anchoring plates to conform to latest Texas State University anchoring system as specified by the Facilities Department.
- B. Contract drawings and specifications shall contain details and specifications for signs and anchorage installation methods.
- C. Perform signage and graphics work in accordance with approved shop drawings and Contract Documents.
- D. The completed signage and graphics work shall be square, level, uniform, clean, free of scratches, nicks, discoloration and other conditions which affect appearance and performance.
- E. Use materials and cleaning method recommended by materials manufacturer.
- F. Do not use acids, cleaning compounds, wire brushes and other type of abrasives.

Exhibit 1: Building Name Signs (Secondary). (37.5" W x 72" H)

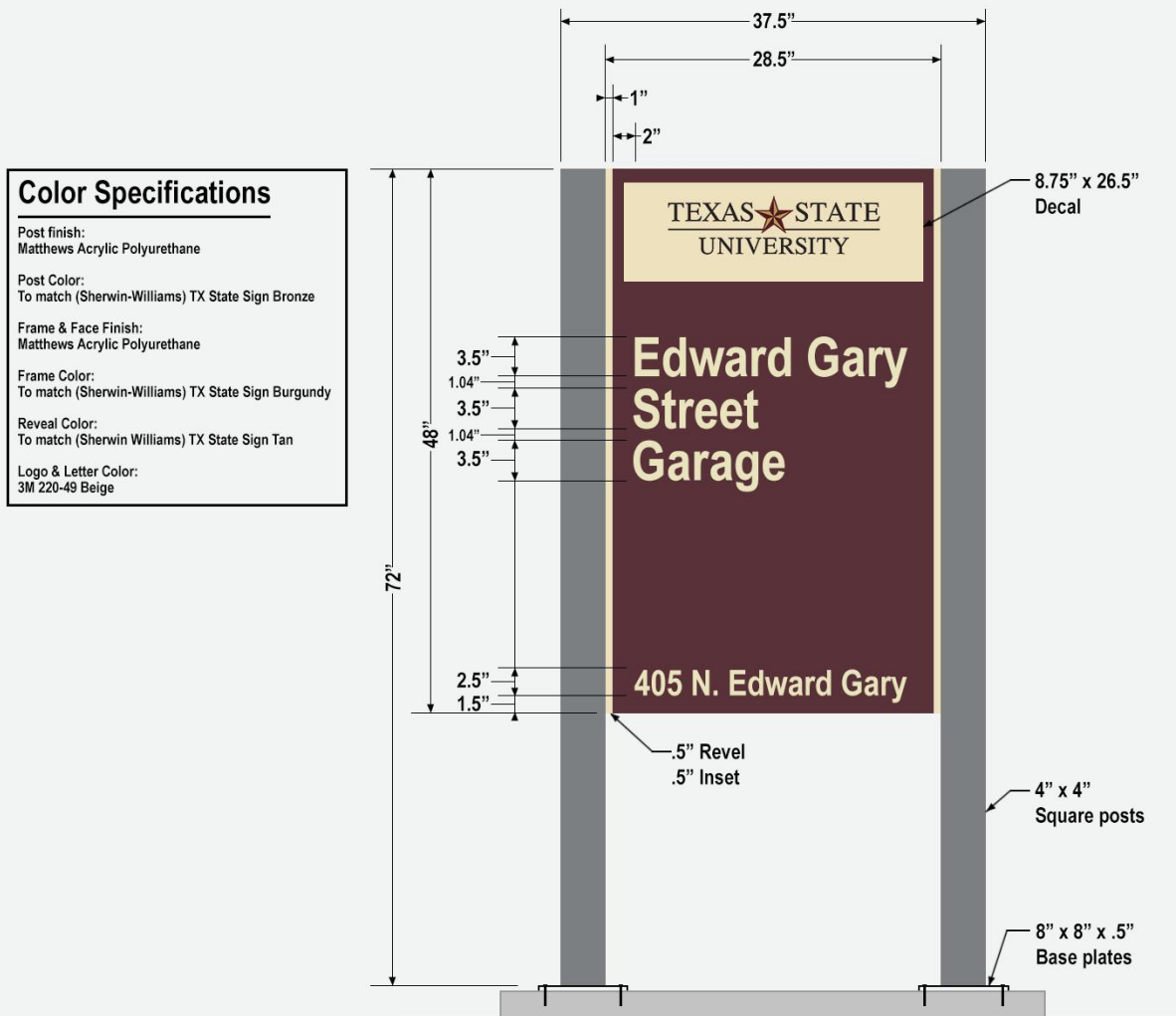

- (1) Secondary sign to be built as per signage graphic standards for Texas State University. Sign to have verbiage on one side as per drawings above (logo on both sides). Concrete footings & installation to be done by others.

Exhibit 2: Building Name Signs (Primary). (50" W x 96" H)

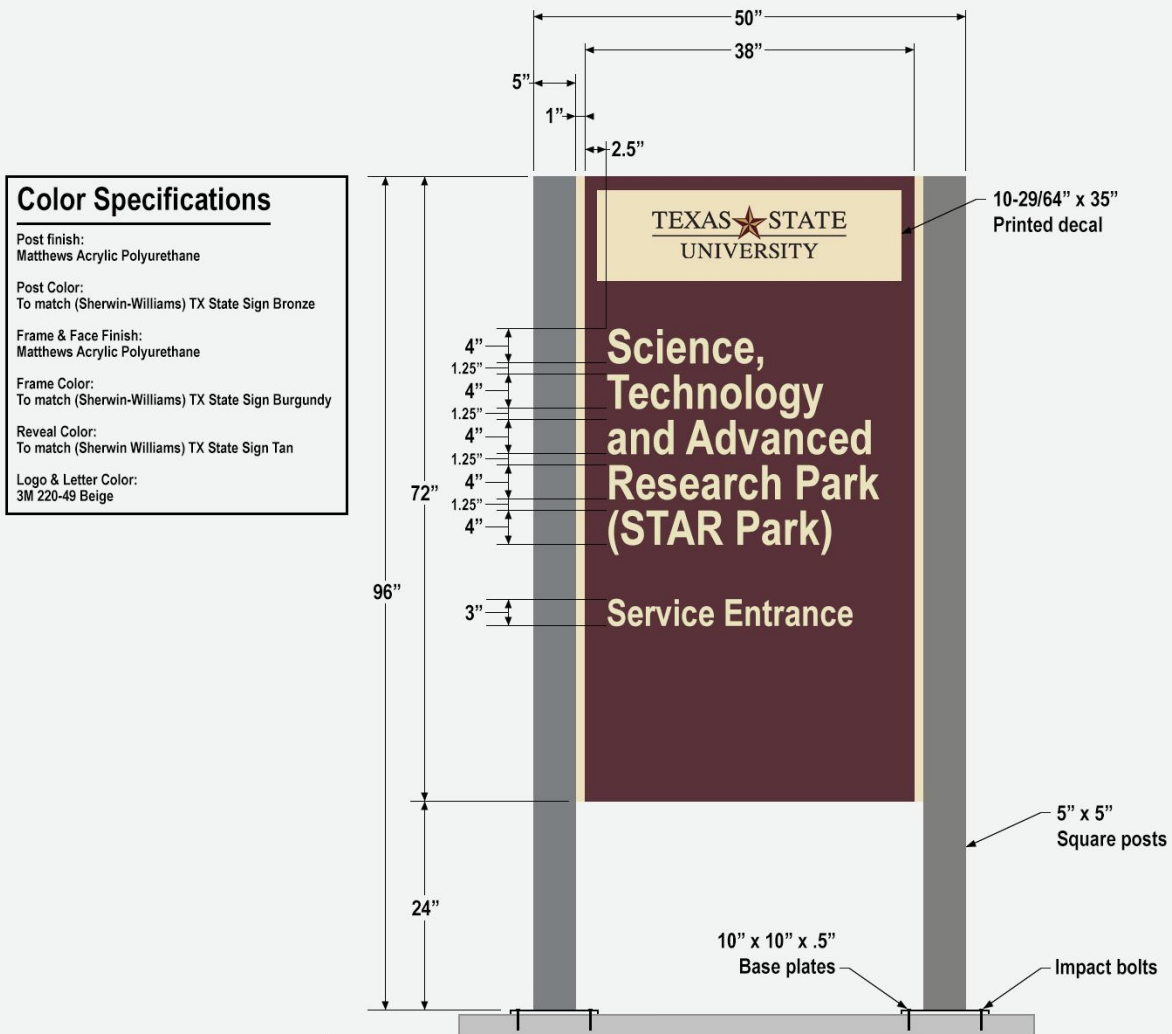

- (1) Primary sign to be built as per signage graphic standards for Texas State University. Sign to have verbiage on both sides as per drawings above (logo both sides). Concrete footings & installation to be done by others.

EXHIBIT 3: Sherwin-Williams Custom Paint Codes

SHERWIN-WILLIAMS 7054 10/13/17
 512-392-0101 Order# 0191792

INT/EXT IND MAINT PART 1
 DIRECT TO METAL ALKYD
 SEMI-GLOSS STANDALONE

TX STATE SIGN BRONZE
 CUSTOM MANUAL MATCH

BAC COLORANT	OZ	32	64	128
W1-White	-	44	1	1
B1-Black	4	40	-	-
G2-New Green	-	1	-	1
R2-Maroon	-	13	-	1
Y3-Deep Gold	-	44	-	1

ONE GALLON ULTRADEEP
 B55T00104 1360064

SHERWIN-WILLIAMS 7054 10/13/17
 512-392-0101 Order# 0191792

EXTERIOR PROFESSIONAL
 SHER-KEM ENAMEL
 HIGH GLOSS STANDALONE

TX STATE SIGN BURGUNDY
 CUSTOM MANUAL MATCH

BAC COLORANT	OZ	32	64	128
B1-Black	-	59	1	1
N1-Raw Umber	-	-	1	1
R3-Magenta	-	11	-	1
R4-New Red	6	52	1	-

ONE GALLON ULTRADEEP
 F75CC0002 601649379

SHERWIN-WILLIAMS 7054 10/17/17
 512-392-0101 Order# 0191970

INT/EXT IND MAINT
 INDUSTRIAL ENAMEL ALKYD
 GLOSS STANDALONE

TX STATE SIGN TAN
 CUSTOM MANUAL MATCH

BAC COLORANT	OZ	32	64	128
N1-Raw Umber	-	34	1	-
Y3-Deep Gold	-	18	-	1

ONE GALLON PURE WHITE
 B54W00101 790799993

Primary and Secondary Sign Foundation

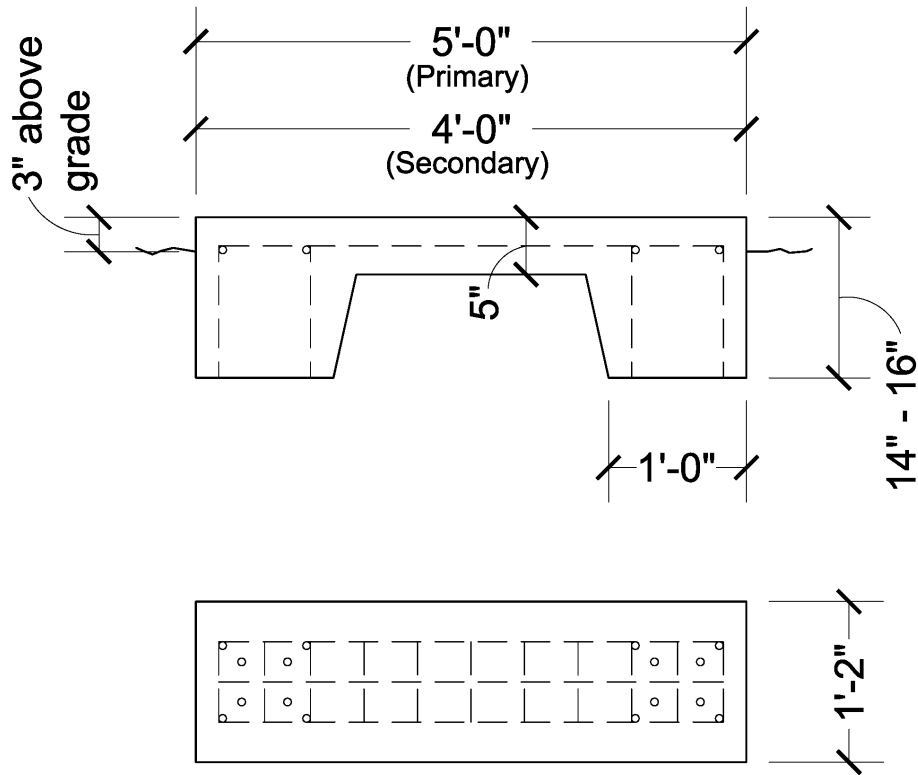

Notes

- 5" conc. base
- All $\frac{3}{8}$ " \varnothing Rebar
- 14" - 16" turn-downs @ each end
- Simpson Strong Tie Anchor Sys
- $\frac{3}{8}$ " x 4" for 6' signs

<p>601 University Drive San Marcos, Texas 78666-4616 Phone: (512)245-2202 Fax (512)245-8839</p>	Title: Concrete Foundation	Sheet No.:
	Double Pole Sign	1 of 1
	File updated: 3/20/2025 Plot Date: 3/20/2025	
	File name: TSU Sign Foundation	

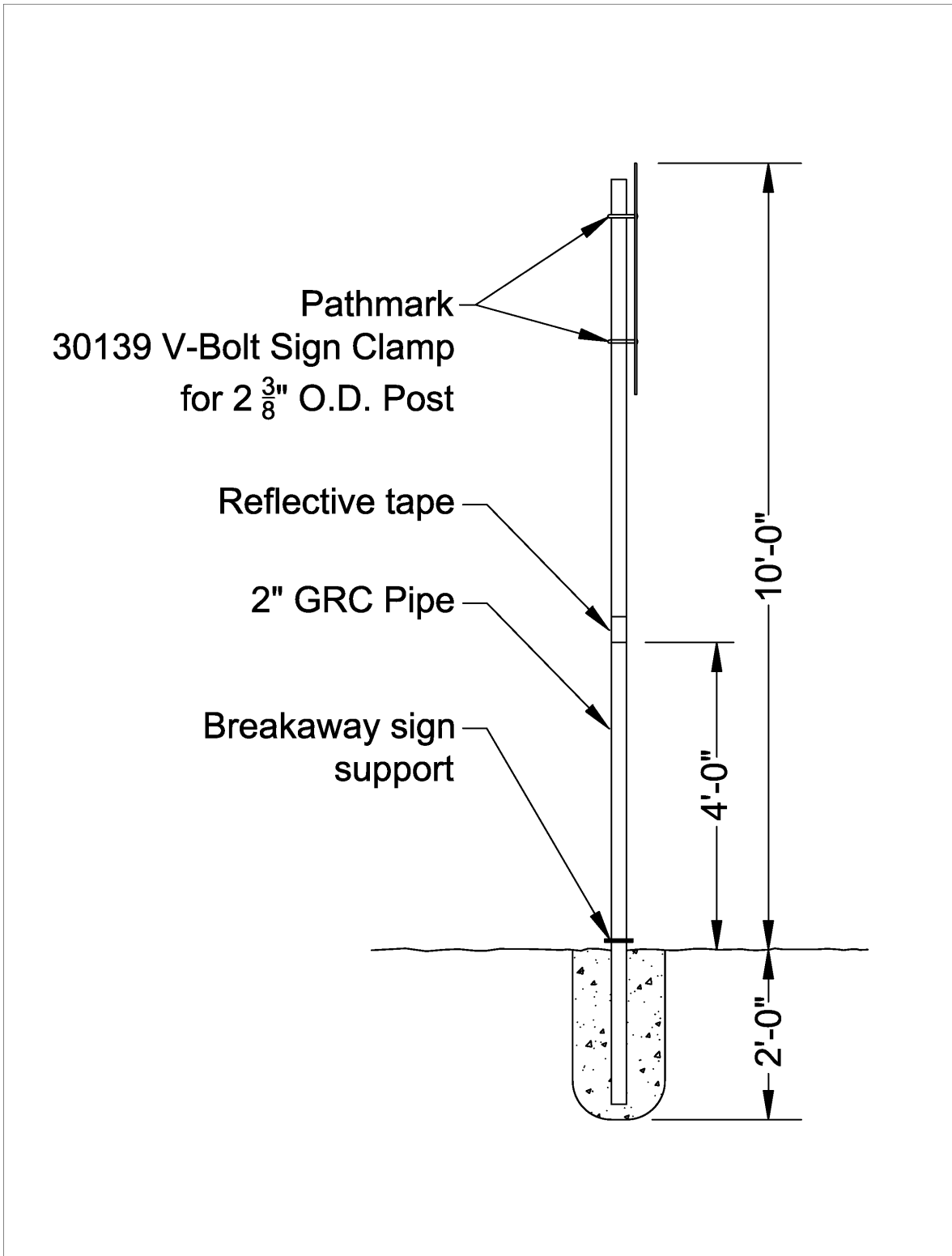

END OF SECTION 10 14 01